

J.I.C. RESERVOIRS - DIN STYLE C

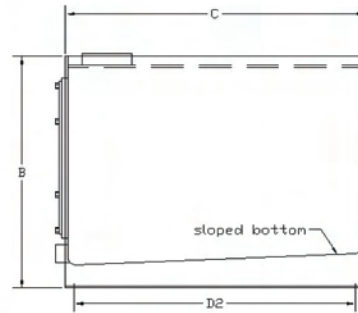
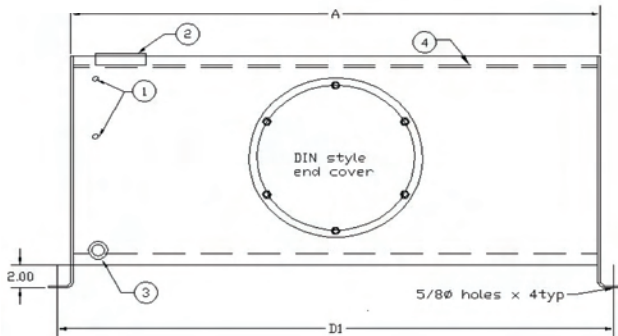

Each "DIN" Style Reservoir includes:

1. (1) Oil Level & Temp. gauge holes
 2. (1) Riser for Filler Breather
 3. (1) #12sae drain
 4. recessed lid 3/4" to create drip lip
- Exterior of Reservoir prime painted
Interior coated with rust preventive oil

Sight Gauge:

- 10 to 80 Gal – 5" Sight Gauge (SLG-5T)
- 100 Gal & up – 10" Sight Gauge (SLG-10T)

Filler Breather:

- Bayonet Style – 40 micron (FBA-1-3S)

D.I.N. RESERVOIRS -STYLE DCH Heavy duty reservoirs												
PART #	CAPA. (GALS)	A length	B height	C width	MOUNTING CENTERS		END COVER	SIGHT GAUGE	PLATE THICKNESS			WEIGHT (lbs)
					D1 +/- 1/8"	D2 +/- 1/8"			END	TOP	BODY	
DCH-20	20	28"	17"	18"	26-1/2"	15-1/2"	DIN 324	5"	3/16"	3/16"	10 ga	120
DCH-30	30	34"	17-1/2"	20-3/4"	32-1/2"	18-1/4"	DIN 324	5"	3/16"	3/16"	10 ga	160
DCH-40	40	40"	18-3/4"	20-3/4"	38-1/2"	18-1/4"	DIN 324	5"	3/16"	3/16"	10 ga	190
DCH-60	60	46"	20-1/4"	24"	44-1/2"	21-1/2"	DIN 324	5"	3/16"	3/8"	10 ga	220
DCH-80	80	46"	21-3/8"	30"	44-1/2"	27-1/2"	DIN 324	5"	3/16"	3/8"	10 ga	285
DCH-100	100	46"	25-1/4"	30"	44-1/2"	27-1/2"	DIN 449	10"	3/16"	3/8"	10 ga	350
DCH-120	120	52"	26-1/4"	30"	50-1/2"	27-1/2"	DIN 449	10"	3/16"	3/8"	10 ga	530
DCH-150	150	64"	26-1/4"	30"	62-1/2"	27-1/2"	DIN 449	10"	3/8"	3/8"	10 ga	635
DCH-200	200	76"	25-3/4"	36"	74-1/2"	33-1/2"	DIN 449	10"	3/8"	3/8"	3/16"	930

D.I.N. RESERVOIRS -STYLE DCL Light duty reservoirs												
PART #	CAPA. (GALS)	A length	B height	C width	MOUNTING CENTERS		END COVER	SIGHT GAUGE	PLATE THICKNESS			WEIGHT (lbs)
					D1 +/- 1/8"	D2 +/- 1/8"			END	TOP	BODY	
DCL-20	20	34-1/4"	16"	18"	32-3/4"	15-1/2"	DIN 324	5"	3/16"	3/16"	10 ga	90
DCL-35	35	39-1/4"	16-3/4"	24"	37-3/4"	21-1/2"	DIN 324	5"	3/16"	3/16"	10 ga	160
DCL-60	60	46-1/8"	18-1/4"	26"	44-5/8"	23-1/2"	DIN 324	5"	3/16"	1/4"	10 ga	210
DCL-80	80	52-1/8"	20-1/4"	27"	50-5/8"	24-1/2"	DIN 324	5"	3/16"	1/4"	10 ga	255
DCL-100	100	61-1/8"	20-1/4"	30"	59-5/8"	27-1/2"	DIN 449	10"	3/16"	1/4"	10 ga	260
DCL-120	120	64-1/8"	21-1/4"	30"	62-5/8"	27-1/2"	DIN 449	10"	3/16"	1/4"	10 ga	420
DCL-150	150	64-1/8"	25-1/4"	30"	62-5/8"	27-1/2"	DIN 449	10"	1/4"	3/8"	10 ga	555
DCL-200	200	76"	24"	36"	74-1/2"	33-1/2"	DIN 449	10"	1/4"	3/8"	10GA	850

Dimensions are approximate & subject to change without notice.